

3-PC Casting Ball Valve Full Port, Direct Mount, 1000 WOG, High Performance

KV-L30, KV-L31, KV-L31-L, KV-L32, KV-L3F (Direct Mount Type)

FEATURES:

- Built-in ISO 5211 Direct Mounting Pad and Square Stem for Easy Automation
- Anti-Static Devices for Ball-Stem-Body
- Blow-out Proof Stem
- Pressure Balance Hole in Ball Slot
- Pre-Load 2 Belleville Washers to Self-adjust Packing
- **TA-LUFT** Design Approved
- Options: 1. Actuator 2. Limit Switch 3. Positioner

STANDARDS:

- Design: MSS SP-110
- Wall Thickness: EN 12516-3
- Pipe Thread **KV-L30**: ASME B1.20.1
DIN 2999 / 259, ISO 228 / 1
JIS B 0203, ISO 7 / 1
- Butt Weld **KV-L31**: ASME B16.25 (ØB2 Sch 40)
- Extended Butt Weld **KV-L31-L**: ASME B16.25 (ØB2 Sch 40)
- Socket Weld **KV-L32**: ASME B16.11
- Flanged Ends **KV-L3F** :
KV-L3F(1) : ASME CLASS 150, KV-L3F(2) : ASME CLASS 300
KV-L3F(J) : PN10, KV-L3F(K) : PN16, KV-L3F(M) : PN25, KV-L3F(N) : PN40 EN 1092-1
KV-L3F(A) : JIS 10K, KV-L3F(C) : JIS 20K B 2220
- Inspection & Testing: MSS SP-110

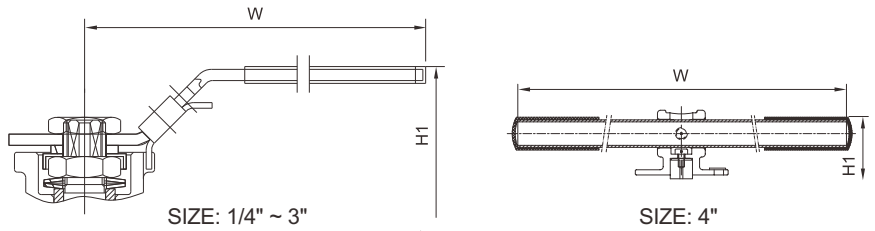
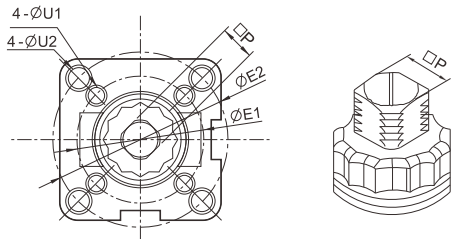
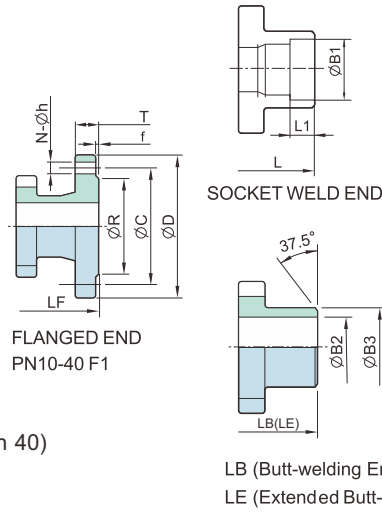

NO.	PART NAME	MATERIALS		
1	Body	CF8M	CF8	WCB
2	Cap (Thread)	CF8M	CF8	WCB
	Cap (Welding)	CF3M	CF3	
3	Ball	CF8M	CF8	
4	Ball Seat	TFM 1600 / PTFE / RTFE		
5	Stem	316	304	
6	Anti-Static Device	316	304	
7	Thrust Washer		PTFE	
8	O-Ring		FKM	
9	Stem Packing		PTFE	
10	Bushing	50%SS+50%PTFE		
11	Gland	316		
12	Belleville Washer		301	
13	Stem Nut		A194-8	
14	Stop-Lock-Cap		304	
15	Bolting	A193-B8/A2-70		
16	Bolt Washer		304	
17	Bolt Nut	A194-8/A2-70		
18	Body Gasket		PTFE	
19	Hex Bolting	A2-70		
20	Actuator	Pneumatic KP / Electric KQ		

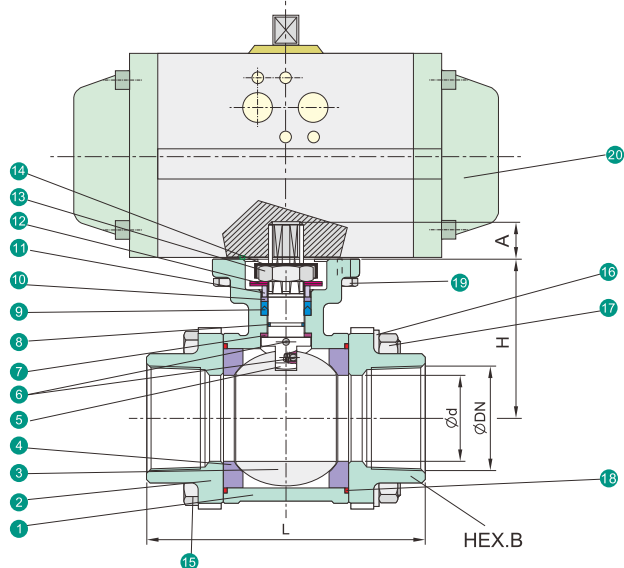

Unit: mm

SIZE	d	L	LB	LE	LF	H	H1	W	E1	E2	P	U1	U2	A	D	C	R	T	f	N	h	L1	B1	B2	B3	ISO 5211
1/4"	10.6	75	70	225	—	42.0	69.0	145	36	42	9	6	6	9	—	—	—	—	—	—	—	10	14.2	9.3	18	F03-F04
3/8"	12.7	75	70	225	—	42.0	69.0	145	36	42	9	6	6	9	—	—	—	—	—	—	—	10	17.8	12.5	18	F03-F04
1/2"	15.0	75	75	225	130	42.0	69.0	145	36	42	9	6	6	9	95	65	45	16	2	4	14	10	21.8	15.8	22	F03-F04
3/4"	20.0	80	90	225	150	48.5	76.0	145	36	50	9	6	7	9	105	75	58	18	2	4	14	13	27.3	20.9	28	F03-F05
1"	25.0	90	100	245	160	58.5	89.0	175	42	50	11	6	7	11	115	85	68	18	2	4	14	13	34.0	26.7	34	F04-F05
1-1/4"	32.0	110	110	255	180	63.0	93.5	175	42	70	11	6	9	11	140	100	78	18	2	4	18	16	42.8	35.1	43	F04-F07
1-1/2"	38.0	120	125	260	200	71.3	103.0	195	50	70	14	7	9	14	150	110	88	18	3	4	18	16	48.9	40.9	50	F05-F07
2"	50.0	140	150	275	230	78.2	109.0	195	50	70	14	7	9	14	165	125	102	20	3	4	18	17	61.4	52.5	61	F05-F07
2-1/2"	63.5	185	190	330	290	100.0	147.0	295	70	102	17	9	11	17	185	145	122	22	3	8	18	17	74.0	62.7	76	F07-F10
3"	76.0	205	220	356	310	108.5	154.0	295	70	102	17	9	11	17	200	160	138	24	3	8	18	17	90.0	78.0	92	F07-F10
4"	100.0	240	270	432	350	140.0	205.0	400	—	102	22	—	11	22	235	190	162	24	3	8	22	20	115.1	102.4	115	F10

*M3 Face to Face dimensions are available